

# Institutional Locksmiths Association

ILA GLC P.O. Box 9554 Naperville, IL 60567-0554 ilaglc.com

**ILA**  
**Since 1983**  
**34 years**

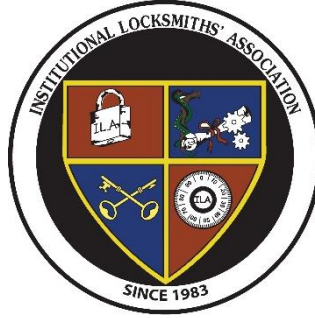

**GLC**  
**Since 1998**  
**19 years**

## Great Lakes Chapter Newsletter

### Meeting Notice April 11, 2019

#### General Membership Meeting

The meeting will be a presentation  
On The Various DORMAKABA Products  
With a focus on the DHW Cluster Brands,  
Best, Precision, Stanley Commercial Hardware & DORMA,

#### Introducing DORMAKABA EAD Group

Presented by Kirk Durall

Food and Beverage sponsored by  
DORMAKABA Products

Guests are always welcome  
At no charge to the ILA/GLC meetings

Location of Meeting  
Carpenter Training Center

1256 Estes Avenue, Elk Grove Village, IL 60007  
6:30 food - 7:00 presentation - chapter meeting afterward  
ilaglc.com – (708) 289-1023

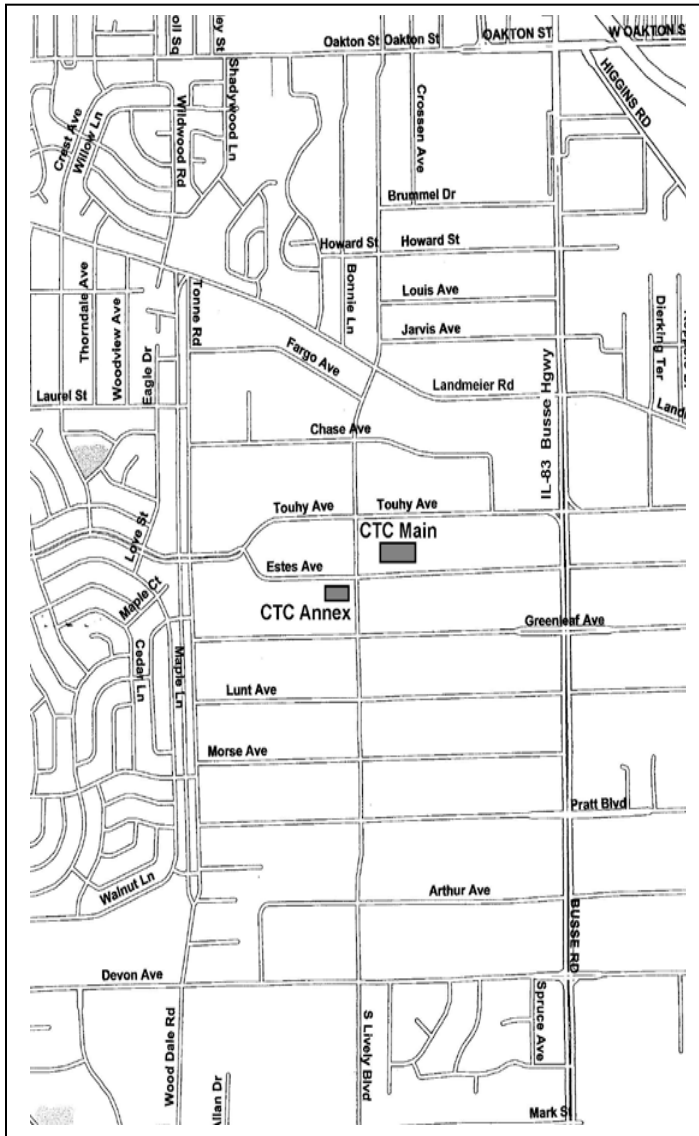

### CTC MAIN Meeting Location Directions

The **Carpenter Training Center** is located at 1256 Estes Ave., Elk Grove Village; one block south of Touhy Ave. and One long block west of IL-83 Busse Rd.; 1.5 miles from the West boundary of O'Hare airport.

#### **From I-90 Northwest Toll way & Elmhurst Road**

Exit Elmhurst Rd. southbound .4 miles to Landmeier Rd. Westbound .9 miles to I-83 Busse Rd. or Kingery Hwy Southbound .4 miles to Estes Ave. westbound - the CTC is on the NE corner of Estes Ave. & Lively Blvd, the Parking is on the west side of the building.

#### **From I-90 Northwest Toll way & Arlington Heights Road**

Exit Arlington Heights Rd. southbound 1.5 miles to Landmeier Rd. eastbound 1.1 miles to Lively Blvd Southbound .5 miles to Estes Ave. eastbound - the CTC is On the NE corner of Estes Ave. & Lively Blvd, the Parking is on the west side of the building.

#### **From I-290 (north of I-355) & Thorndale Avenue**

Exit Thorndale Ave. eastbound 2.5 miles to Lively Blvd Northbound 1.5 miles to Estes Ave. eastbound - the CTC is On the NE corner of Estes Ave. & Lively Blvd, the Parking is on the west side of the building.

#### **From I-290 Eisenhower Extension (west of Elmhurst) & 83 Busse Rd. (Kingery Hwy.)**

Exit I-83 northbound 6 miles to Greenleaf Ave. Westbound one long block to Lively Blvd. northbound 1 Block to Estes Ave. eastbound - the CTC is on the NE Corner of Estes Ave. & Lively Blvd, the parking is on the West side of the building

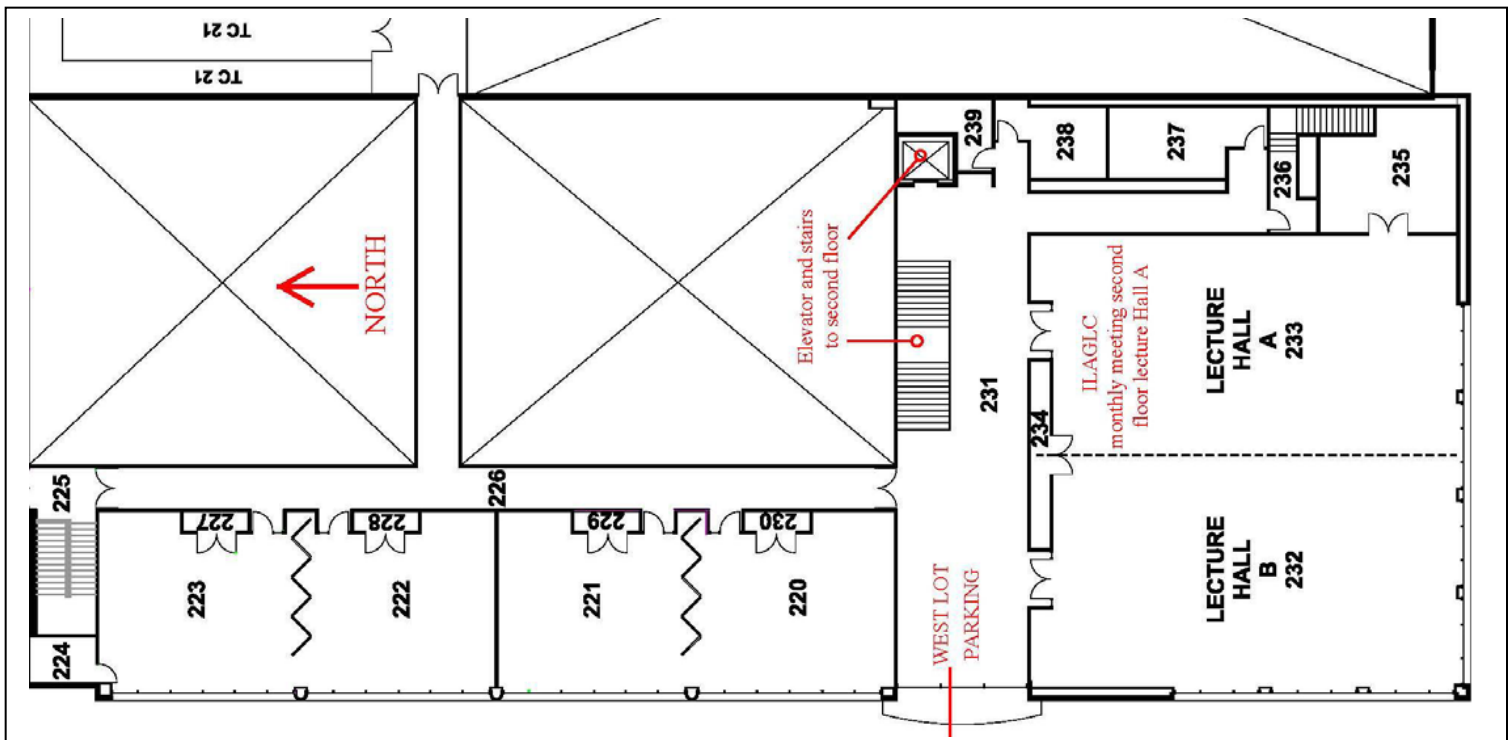

**ILA GLC**  
**P.O. Box 9554**  
**Naperville, IL 60567-0554**  
**ilaglc.com**

**President** Kevin Piper CIL  
DOOR, FRAME, HARDWARE  
Installation & Repair Specialists  
(708) 289-1023 cell  
codicco@aol.com

**Vice President** Bob Akin, CRL, CAL, CIL  
Larry's Lock Service  
(630) 878-4679 cell  
larryslockbolingbrook@comcast.net

**Secretary**  
Unfilled at present

**Treasurer** Kurt Kloeckner, TCPL, CJIL  
Carpenter Local 558  
(630) 726-8729 cell  
brotherkeyman@aol.com

**Sergeant at Arms** Art Misiewicz, CRL, CIL  
Metrolock  
(773) 384-1074  
metrolock.1@juno.com

**Newsletter/ Director** Pat Moran, CIL  
University of Illinois at Chicago  
pmoran@uic.edu  
(847) 707-8536 cell

**Director** Rich Crnich, CIL  
University of Illinois at Chicago  
(312) 339-5140 cell  
(Retired)

**Director** Art Urbano, CIL  
Carpenter Training Center  
(708) 533-0202 cell  
aurbano@chicap.org

## ILA Mission Statement

We are locksmiths, carpenters, and building engineers employed by and/or working for colleges, universities, hospitals, companies, institutions and government facilities. We are involved in the installation, servicing, maintenance, specifying and/or recommending of security and life safety hardware.

Together, and individually, we are dedicated to the improvement of our profession. We strive to educate ourselves and increase our knowledge and ability, for our benefit and for the benefit of the institutions that we serve.

We strive to encourage good fellowship among our members by cooperating in advancing the best interests of the profession and the voluntary interchange of experience, training, and special knowledge.

### GLC Membership Numbers

	Total	Renewed	Not yet renewed
<b>Regular Members</b>	126	101	25
<b>Associate Members</b>	26	16	10
<b>Corporate Individual Members</b>	3	3	0



# ILAGLC Calendar

## **May 9, 2019 Regular Monthly Meeting**

**Carpenters Training Center Main Building Elk Grove Village, 6:30 pm**

No scheduled presentation at this time anyone interested contact President Kevin.

No scheduled sponsor at this time anyone interested contact President Kevin.

No scheduled Associate Tabletop at this time anyone interested? Contact President Kevin

## **June 13, 2019 Regular Monthly Meeting**

**Carpenters Training Center Main Building Elk Grove Village, 6:30 pm**

No scheduled presentation at this time anyone interested contact President Kevin.

No scheduled sponsor at this time anyone interested contact President Kevin.

No scheduled Associate Tabletop at this time anyone interested? Contact President Kevin

## **July 26, 2019 18th, Annual Golf Outing**

**Great Lakes Chapter Sixteenth Annual Golf Outing at Gleneagles Country Club**

**13070 McCarthy Rd. Lemont, IL. Save the Date**

Details to follow in future newsletters Save the date

ILA/GLC P.O Box 9554 Naperville Il 60567-0554

Contact Kurt Kloeckner (630) 726-8729

## **No Scheduled Meetings July or August**

## **September 12, 2019 Regular Monthly Meeting**

**Carpenters Training Center Main Building Elk Grove Village, 6:30 pm**

No scheduled presentation at this time anyone interested contact President Kevin.

No scheduled sponsor at this time anyone interested contact President Kevin.

No scheduled Associate Tabletop at this time anyone interested? Contact President Kevin

## **October 10, 2019 Regular Monthly Meeting**

**Carpenters Training Center Main Building Elk Grove Village, 6:30 pm**

No scheduled presentation at this time anyone interested contact President Kevin.

No scheduled sponsor at this time anyone interested contact President Kevin.

No scheduled Associate Tabletop at this time anyone interested? Contact President Kevin

## **November 8, 2018 Regular Monthly Meeting**

**Carpenters Training Center Main Building Elk Grove Village, 6:30 pm**

No scheduled presentation at this time anyone interested contact President Kevin.

No scheduled sponsor at this time anyone interested contact President Kevin.

No scheduled Associate Tabletop at this time anyone interested? Contact President Kevin

Contact President Kevin [Piper-codicco@aol.com](mailto:Piper-codicco@aol.com) to schedule presentations, sponsorship or arrangements for the associate table top

# Support our Associate & Corporate Members - They Support Us

## **ALLEGION**

2171 Executive Drive, Suite 200  
Addison, Illinois 60101-5600  
(877) 282-1721  
William Giovanni, Sale Consultant Ext.-4815  
Jim Bakke Sales Consultant Ext. 4810  
John Lozano Sales Consultant Ext. 4809

ILAGLC Associate Member

## **ASSA ABLOY**

Bill Power, Director of Sales - Wholesale  
Yorba Linda, California  
(714) 779-7200

**ILA National Associate Member Representative**

ILAGLC Associate Member

## **ASSA ABLOY Door Security Solutions North Central**

718 Foster Avenue  
Bensenville, Illinois 60106-1509  
(630) 594-1500  
Michael Alderman  
Denise Haberkorn

## **Carpenters Local 1**

1327 W. Washington Boulevard, Suite 101  
Chicago, Illinois 60607-1913  
(312) 850-0848

## **Chicago Doorways**

219 W Diversey Avenue  
Elmhurst, Illinois 60126-1103  
(630) 279-2227  
Andrew J. Dellamaria, Managing Partner  
Jeff Brennan, Managing Partner

## **Chicago Regional Council of Carpenters**

### **ILA Corporate Member**

12 East Erie Street  
Chicago, Illinois 60611-2796  
(312) 787-3076

## **Chicago Regional Council of Carpenters ILA Sponsor**

### **Apprentice and Training Program**

1256 Estes Avenue  
Elk Grove Village, Illinois 60007  
(847) 640-7373 [www.chicap.com](http://www.chicap.com)

## **CLARK Chicago Branch**

1420 Chase Avenue  
Elk Grove Village, Illinois 60007-4825  
(800) 755-5625 (847) 718-0519  
Danny Chmelina, Account Manager  
ILA Individual Member

## **CLARK Security Products**

### ILA Corporate Member

4775 Viewridge Avenue  
San Diego, California 92123-1641  
(800) 854-2088  
Anaheim (800) 889-5625  
Dallas (800) 483-5625  
Denver (800) 282-5625  
Kentucky (800) 659-5625  
Las Vegas (800) 775-5625  
New England (800) 746-5625  
Orlando (800) 669-5625  
Phoenix (800) 775-5625  
Sacramento (800) 245-3003  
Salt Lake City (800) 453-6430  
San Diego (800) 542-5625  
Seattle (800) 942-5275  
Washington D.C. (800) 578-5625

## **CLARK Chicago Branch**

1420 Chase Avenue  
Elk Grove Village, Illinois 60007-4825  
(800) 755-5625 (847) 718-0519  
Danny Chmelina, Account Manager  
ILA Corporate Individual Member

## **Detex Corporation ILA Corporate Member**

302 Detex Drive  
New Braunfels, Texas 78130-3045  
(888) 384-6673  
Tim Shafer, Institutional Sales Manager  
Scott Peck, Power Operator Training & Manager

## **Dugmore & Duncan, Inc.**

ILA Corporate Member  
30 Pond Park Road  
Hingham, Massachusetts 02043-4340  
(800) 729-3839  
Jack Walder, CJIL, Sales & Technical Support

## **ETI Products**

2V East Main Street  
Amboy, Illinois 61310-1638  
(847) 384-3841

## **ICOR Products.**

### ILA-Associate Member

PO Box 161 Western Springs, IL 60558  
(708) 246-6769-fax (708) 246-1051  
Wes McKinney CRL, CIL-  
[wes@icorproducts.com](mailto:wes@icorproducts.com) (708) 491-5869

## Support our Associate & Corporate Members - They Support Us

### **IDN H Hoffman Inc.**

Corporate Headquarters  
7330 W. Montrose Avenue  
Norridge, Illinois 60706-1158  
(708) 456-9600  
Chicago (708) 456-9600  
Cincinnati (513) 271-8530  
Columbus (614) 436-6619  
Davenport (563) 391-8366  
Des Moines (515) 299-4622  
Grand Rapids (616) 534-1067  
IDN One Stop Door (630) 628-9441  
Indianapolis (317) 635-8100  
Kansas City (913) 599-4111  
Milwaukee (262) 790-9750  
Minneapolis (952) 886-3840  
Omaha (402) 592-1652  
St. Louis (314) 692-8391

#### **Chicago Branch**

7330 W. Montrose Avenue  
Norridge, Illinois 60706-1158  
(708) 456-9600  
Dan Lam, Inside Sales Manager

### **Intermountain Lock & Security Supply Co.**

ILA Corporate Member  
3106 S. Main Street  
Salt Lake City, Utah 84115-3731  
(800) 485-7205  
Denver (800) 323-8046 Gary Brienzi  
Las Vegas (800) 809-5625 Brandon Cline  
Los Angeles (800) 729-5444 Mike Katz  
Phoenix (877) 438-6068 Brian Swindler  
Salt Lake City (800) 453-5386 Paul Crump

### **LAB Security Systems Corporation**

ILA- Corporate Member  
700 Emmett Street  
Bristol, Connecticut 06010-7714  
(800) 243-8242  
Robert Labbe Owner  
George Bertram, Hardware Specialist  
(708) 799-8783

### **Medeco High Security Locks Inc.**

ILA Corporate Member  
3625 Allegheny Drive  
Salem, Virginia 24153-0330  
(800) 829-3157

### **Mil-Comm Products Company**

ILA Corporate Member  
2 Carlton Avenue  
East Rutherford, New Jersey 07073-1646  
(888) 947-3273

### **Pacific Lock Company**

ILA Corporate Member  
2515 Hercules Street  
Valencia, California 91355-5051  
(888) 562-5565  
Greg Waugh, President

### **Prosystech, Inc. - SimpleK**

ILA Corporate Member  
178 Notre-Dame Street  
L'Assomption, Quebec, Canada J5W 4M9  
(888) 601-7806  
Jonathan Bedard, Vice President

### **RG Sales Inc.**

215 N. Arlington Heights Road, Suite 3100  
Arlington Heights, Illinois 60004-6056

### **Securitech Group, Inc.**

ILA Corporate Member  
54-45 44th Street  
Maspeth, New York 11378-1031  
(800) 622-5625  
Mark Berger, President

### **Southern Lock & Supply Co, Inc.**

ILA Corporate Member  
P. O. Box 1980  
Pinellas Park, Florida 33780-1980  
(800) 282-2837  
David Matthies, President

### **Waggoner Brenia Associates**

44W741 Littlewoods Trail  
Hampshire, Illinois 60140-6112  
Peter J. Brenia, AHC, CSI (847) 347-3505  
Northwest Indiana & Wisconsin  
Jeff Waggoner, CSI-(630) 469-8276  
Northwest Indiana & East Wisconsin